



Date: 04-01-2018

### Declaration of Conformity

We, PROCOM A/S, Smedetoften 12, DK-3600 Fredreikssund, Denmark hereby guarantee that the below listed product(s):

Description	Type
MU 7-LX/h.	Unity Gain $\frac{1}{4} \lambda$ Mobile Antenna for the 450 MHz Band.

are manufactured / delivered by our company either direct or through any third parties (including subsidiaries and affiliated companies) are in conformity with the below mentioned directives:

- 2014/30/EU**                    The Electromagnetic Compatibility Directive.
- 2014/35/EU**                    Radio Equipment Directive.
- 2011/65/EU**                    The Restriction of Hazardous Substances Directive.
- 2015/386 EU**                    The amending annex II to Directive 200/56/EU
- 1907/2006/EU**                    Registration, Evaluation, Authorization and  
restriction of chemicals
- 2006/96/EC**                    Waste Electrical and Electronic Equipment, "WEEE"  
(Procom A/S is a member of the Danish electronic waste collection and  
treatment association called "Elretur". Please see [www.elretur.dk](http://www.elretur.dk)  
Procom member no. is 87 92 82 17.

For ATEX Products we are in conformity with the directive:

- 2014/34/EU**                    Atmospheres Explosives Directive.

PROCOM A/S Active products are in accordance with all applicable requirements and labels with CE mark as required.

  
 Authorized Signature:  
 Adnan Ahmad  
 Director of Engineering  
 Procom A/S  
 +45 48 27 02 77



# MU 7-LX/...

Unity Gain  $1/4 \lambda$  Mobile Antenna for the 450 MHz Band

## DESCRIPTION

- 0 dB mobile antenna with silicone covered flexible steel wire whip.
- Type MU 7-LX/s covers 370–410 MHz  
Type MU 7-LX/l covers 406–440 MHz  
Type MU 7-LX/h covers 430–470 MHz  
– no tuning required.
- Stainless steel LX-mount – professional quality in elegant and smooth design.
- Especially suited for roof-mounting.
- Provided with FME-connection (supplied without cable).
- Bendable section in mount for adjustment of whip (tiltable  $15^\circ$  by hand).
- Installation with access from the outside only (requiring an 18 mm dia. hole).



## ORDERING DESIGNATION

FREQUENCY RANGE	TYPE NO.
370-410 MHz	MU 7-LX/s
406-440 MHz	MU 7-LX/l
430-470 MHz	MU 7-LX/h

## SPECIFICATIONS

ELECTRICAL	
MODEL	MU 7-LX/...
ANTENNA TYPE	$1/4 \lambda$ mobile whip antenna
FREQUENCY	450 MHz band covered by three models
IMPEDANCE	Nom. 50 $\Omega$
POLARISATION	Vertical
GAIN	0 dB (acc. to EIA RS-329-1)
BAND WIDTH	$\geq 40$ MHz
SWR	$\leq 1.3$ @ f. res.
MAX. POWER	100 W
MECHANICAL	
MATERIALS	<b>Whip:</b> Steel wire covered with silicone tubing Black-chromed brass <b>Mount:</b> Stainless steel Brass Environment-proof plastics
RECOMMENDED INSTALLATION TORQUE	3.5 Nm max.
CABLE	FME-cable to be ordered separately
COLOUR	Black
HEIGHT	Approx. 160 mm
WEIGHT	Approx. 45 g
MOUNTING	18 mm dia. hole

## INSTALLATION

The LX-mount is especially suited for roof-mounting. It is recommended to mount the antenna at the centre of the roof to ensure the best omnidirectional coverage. Mounting can take place in an 18 mm dia. hole with access from the outside only.

When cleaning the car in car-washing machines, the whip should be removed – a 9 mm fork spanner can be used. After wash, the whip is refitted and tightened lightly with the spanner.

The mount is equipped with a bendable section ( $\pm 15^\circ$ ) to make it possible to adjust the antenna to an upright position.

### 1. INSTALLATION DIMENSIONS:

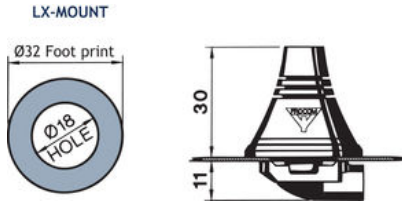

### 2. INSTALLATION STEPS:

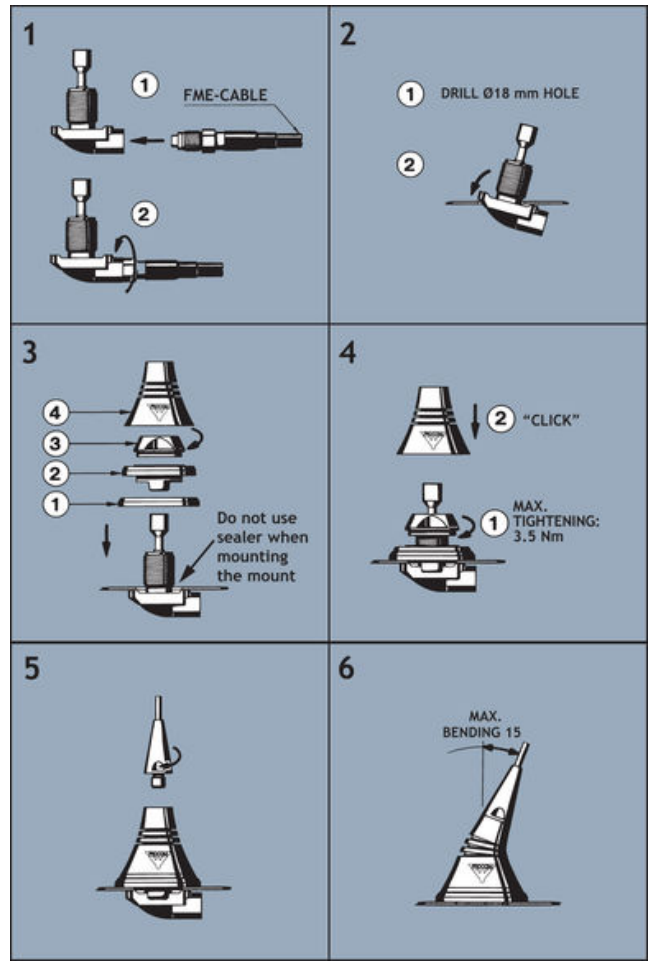

Do not use sealer on rubber gasket or other places.

### 3. TUNING:

The antenna is delivered factory-tuned and requires no further tuning.



PROCOM A/S reserve the right to amend specifications without prior notice.

06/05/2009